

QB

Peripheral Pump



Stainless Steel Inset
(optional)



QB60



QB60-ECO



Model Meaning

QB 60 - ECO



Advantages & Features

- Thicker electrophoretic rust-proof layer on overflow parts for greater durability
- Full copper motor with F-grade insulation for longer life
- Brass impeller to prevent rust and seizure
- Stable water output and low noise operation
- Built-in protection device to prevent the motor from burning out
- Centerless grinding process of the rotor, more durable

Applications

- This series of products is used for domestic water supply, pipeline pressurization, garden irrigation.

Working Conditions

- Transport clean water and other viscous, non-corrosive liquids, and shall not transport flammable, explosive, easily gasified, and solid-containing liquids
- Granular or fibrous liquid with a PH between 6.5-8.5
- The medium temperature of ordinary self-priming pump is +4°C~+40°C
- The volume ratio of solid impurities in the medium is not more than 0.1%, and the particle size is not more than 0.2mm

Package Dimensions

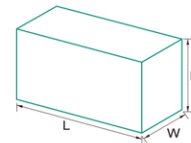

Model	L	W	H
	cm	cm	cm
QB50	26	16	17.5
QB60-ECO	23.5	13.5	17
QB70-ECO	32	17.5	22
QB80-ECO	32	17.5	22
QB60/QBB60	27.5	13.5	17
QB70/QBB70	32	17.5	22
QB80/QBB80	32	17.5	22
QB90	29	29	29

Performance Curve

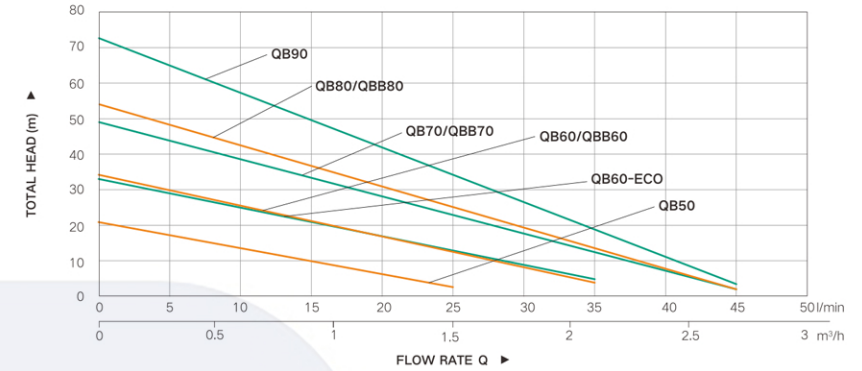

Performance Parameters

Model	Power		Inlet/Outlet	Max.suct	Max.flow	Q(m³/h)																				
	kW	HP	In	m	l/min	0	0.3	0.6	0.9	1.2	1.5	1.8	2.1	2.4	2.7											
QB50	0.22	0.3	1"x1"	8	25	H(m)																				
QB60-ECO	0.37	0.5	1"x1"	8	35																					
QB70-ECO	0.55	0.75	1"x1"	8	45																					
QB80-ECO	0.75	1	1"x1"	8	45																					
QB60/QBB60	0.37	0.5	1"x1"	8	35																					
QB70/QBB70	0.55	0.75	1"x1"	8	45																					
QB80/QBB80	0.75	1	1"x1"	8	45																					
QB90	0.9	1.2	1"x1"	8	45																					
																	0	5	10	15	20	25	30	35	40	45
																	20	17	15	10	5	2	-	-	-	-
						32	27	25	18	14	11	5	2	-	-											
						45	44	40	37	31	20	16	13	2.5	-											
						53	45	44	37	27	20	16	13	4	2											
						35	27	25	18	14	11	5	2	-	-											
						45	44	40	37	31	20	16	13	2.5	-											
						53	45	44	37	27	20	16	13	4	2											
						75	65	60	49	35	30	22	18	12	9											

Product Structure

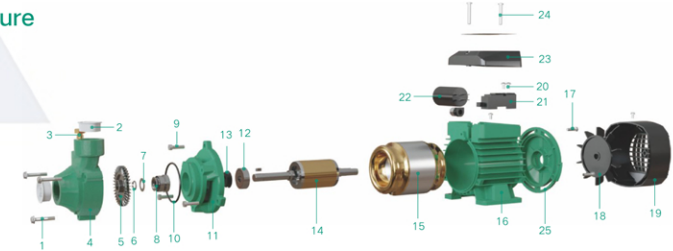

NO.	Part	NO.	Part	NO.	Part	NO.	Part	NO.	Part
1	Screw	6	Locking ring	11	Motor front cover	16	Motor body	21	Circuit board
2	Dust cover	7	Flat washer	12	Upper bearing	17	Screw	22	Capacitor
3	Air bolt	8	Mechanical seal	13	Water washer	18	Fan	23	Terminal box
4	Pump body	9	Screw	14	Rotor	19	Fan cover	24	Screw
5	Impeller	10	O-ring	15	Coil	20	Ground screw	25	Motor end cover